

規格 Specification

型號 Type	EDR100-M5、01	EDR200-01、02、03	EDR400-03、04、06	EDR600-06、08
接管口徑 G Port Size	M5 · 1/8"	1/8" · 1/4" · 3/8"	3/8" · 1/2" · 3/4"	3/4" · 1"
壓力表接管口徑 G Gauge Thread	M5	1/8"	1/4"	
工作介質 Fluid	壓縮空氣 Compressed Air			
使用壓力範圍 MPa Operating Pressure Range	0.15~0.85	0.15~1.2		
最大處理流量 L/min Max. Flow Rate	500	1700	3500	11500
使用溫度範圍 °C Ambient Temperature	-10~60			
過濾精度 Filter Precision	5 μm 或 (or) 40 μm			
杯子材質 Structure	聚碳酸酯 Overflow Type			
防護罩 Guard cup	-	●	●	●

訂購代碼 Ordering Code

EDR — **200** — **01** — **D**

- EDR** 過濾調壓器
EDR Filter Regulator
- 200** 型式
Type
100, 200, 400, 600
- 01** 接管口徑
Port Size
M5, 01: G1/8",
02: G1/4", 03: G3/8",
04: G1/2", 06: G3/4",
08: G1"
- D**
 - : 手動排水
 - D: 自動排水
 - NW: 不附壓力表
 - : Manual Drain
 - D: Auto-Drain
 - NW: Without Gauge

外觀尺寸 Overall Dimension

EDR100-M5、01

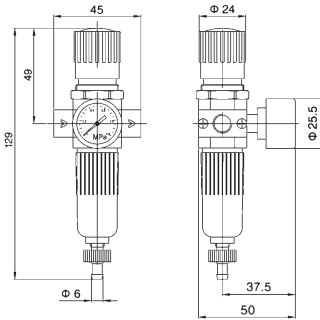

注: M5 接口不帶連接塊 / M5 is without connector.

EDR200-01、02、03

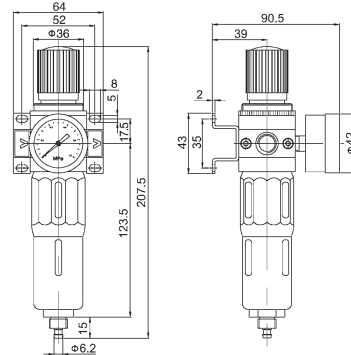

EDR400-03、04、06

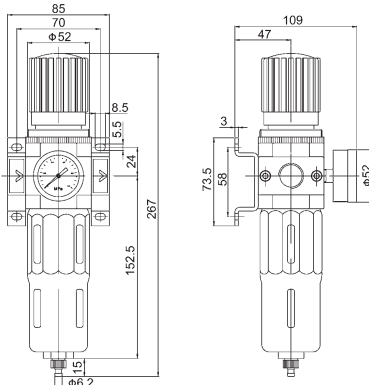

EDR600-06、08

