

MPC

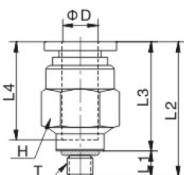

MPC
螺紋直通



公制 Metric-BSPT(R)

型號 Model	ΦD	T	L1	L2	L3	L4	對邊 H
MPC3-M3	3	M3x0.5	3	14.5	11.5	10.5	8
MPC3-M5		M5x0.8	3.5	15	11.5		8
MPC3-M6		M6x1.0	4	15.5	11.5		8
MPC4-M3	4	M3x0.5	3	16	13	11.5	8
MPC4-M5		M5x0.8	3.5	17	13.5		8
MPC4-M6		M6x1.0	4	17.5	13.5		8
MPC4-01		R 1/8	7.5	16	12		10
MPC6-M5	6	M5x0.8	3.5	17.5	14	12.5	10
MPC6-M6		M6x1.0	4	18	14		10
MPC6-01		R 1/8	7.5	16.5	12.5		10

MPCF



MPCF
內螺紋直通

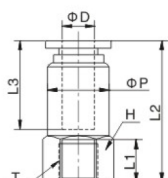

公制 Metric-BSPT(R)

型號 Model	ΦD	T	L1	L2	L3	ΦP	對邊 H
MPCF3-M3	3	M3x0.5	4	15.5	10.5	8	8
MPCF3-M5		M5x0.8	5	17			8
MPCF3-M6		M6x1.0	5	17			8
MPCF4-M3	4	M3x0.5	4	17	11.5	8	8
MPCF4-M5		M5x0.8	5	18.5			8
MPCF4-M6		M6x1.0	5	18.5			8
MPCF4-01		R 1/8	7.5	21.5			12
MPCF6-M5	6	M5x0.8	5	19	12.5	10	10
MPCF6-M6		M6x1.0	5	19			10
MPCF6-01		R 1/8	7.5	22			12

MPLL



MPLL
L型加長螺紋二通

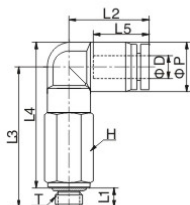

公制 Metric-BSPT(R)

型號 Model	ΦD	T	L1	L2	L3	L4	L5	ΦP	對邊 H
MPLL3-M3	3	M3x0.5	3	12.5	26.5	26.5	10.5	7	8
MPLL3-M5		M5x0.8	3.5		27	26.5			8
MPLL3-M6		M6x1.0	4		27.5	26.5			8
MPLL4-M3	4	M3x0.5	3	14.5	26.5	27.5	11.5	9	8
MPLL4-M5		M5x0.8	3.5		27	27.5			8
MPLL4-M6		M6x1.0	4		27.5	27.5			8
MPLL4-01		R 1/8	7.5		31	31			10
MPLL6-M5	6	M5x0.8	3.5	16.5	27	29	12.5	11	8
MPLL6-M6		M6x1.0	4		27.5	29			8
MPLL6-01		R 1/8	7.5		31	32.5			10

MPB



MPB
T型螺紋三通

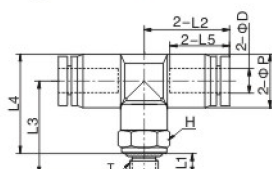

公制 Metric-BSPT(R)

型號 Model	ΦD	T	L1	L2	L3	L4	L5	ΦP	對邊 H
MPB3-M3	3	M3x0.5	3	12.5	15.5	16	10.5	7	8
MPB3-M5		M5x0.8	3.5		16	16			8
MPB3-M6		M6x1.0	4		16.5	16			8
MPB4-M3	4	M3x0.5	3	14.5	15.5	17	11.5	9	8
MPB4-M5		M5x0.8	3.5		16	17			8
MPB4-M6		M6x1.0	4		16.5	17			8
MPB4-01		R 1/8	7.5		19.5	20			10
MPB6-M5	6	M5x0.8	3.5	16.5	16	18	12.5	11	8
MPB6-M6		M6x1.0	4		16.5	18			8
MPB6-01		R 1/8	7.5		19.5	21			10