

EPAF

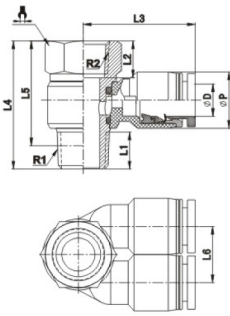

EPAF
回轉內外螺紋四通



公制 Metric-BSPT(R)

型號 Model	ΦD	R1	R2	L1	L2	L3	L4	L5	L6	ΦP	🔩
EPAF4-M5	4	M5		4	5	22.5	20	16	11	11	8
EPAF6-01	6	R 1/8		7	7	24	28	24	13	13	14
EPAF8-01	8	R 1/8		7	7	26	28	24	14.5	14.5	14
EPAF8-02		R 1/4	9.5	9.5	28	33	27	14.5	14.5	17	
EPAF10-02	10	R 1/4		9.5	9.5	31	33	27	18.5	18.5	17
EPAF10-03		R 3/8	10.5	10.5	33	39	32.5	18.5	18.5	21	
EPAF12-03	12	R 3/8		10.5	10.5	34	39	32.5	21	21	21
EPAF12-04		R 1/2	14	14	36.5	46.5	38.5	21	21	24	
EPAF6-G01	6	R 1/8		5	7	24	27.5	22.5	13	13	14
EPAF8-G01	8	R 1/8		5	7	26	27.5	22.5	14.5	14.5	14
EPAF8-G02		R 1/4	7	9.5	28	33	26	14.5	14.5	17	
EPAF10-G02	10	R 1/4		7	9.5	31	33	26	18.5	18.5	17
EPAF10-G03		R 3/8	7.5	10.5	33	39	31.5	18.5	18.5	21	
EPAF12-G03	12	R 3/8		7.5	10.5	34	39	31.5	21	21	21
EPAF12-G04		R 1/2	10	14	36.5	46.5	36.5	21	21	24	

EPHW



EPHW
F 型螺紋回轉三通

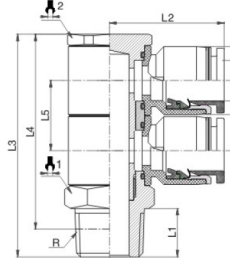

公制 Metric-BSPT(R)

型號 Model	ΦD	R	L1	L2	L3	L4	L5	ΦP	🔩 ¹	🔩 ²
EPHW4-01	4	R 1/8	8	23.5	43	39	13.5	13	14	14
EPHW4-02		R 1/4	11	23.5	46	40	13.5	13	14	14
EPHW6-01	6	R 1/8	8	23.5	43	39	13.5	13	14	14
EPHW6-02		R 1/4	11	23.5	46	40	13.5	13	14	14
EPHW6-03		R 3/8	12	23.5	48	41.5	13.5	13	17	14
EPHW8-01	8	R 1/8	8	27.5	47	43	15	14.5	17	17
EPHW8-02		R 1/4	11	27.5	50	44	15	14.5	17	17
EPHW8-03		R 3/8	12	27.5	51	44.5	15	14.5	17	17
EPHW8-04		R 1/2	15	27.5	55	47	15	14.5	21	17
EPHW10-02	10	R 1/4	11	32	58	52	18.5	18.5	21	21
EPHW10-03		R 3/8	12	32	59	52.5	18.5	18.5	21	21
EPHW10-04		R 1/2	15	32	62	54	18.5	18.5	21	21
EPHW12-02	12	R 1/4	11	35	64.5	58.5	21.5	21	24	24
EPHW12-03		R 3/8	12	35	65.5	59	21.5	21	24	24
EPHW12-04		R 1/2	15	35	68.5	60.5	21.5	21	24	24

EPHT



EPHT
F 型螺紋回轉四通

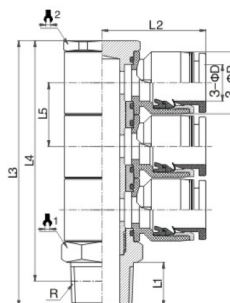

公制 Metric-BSPT(R)

型號 Model	ΦD	R	L1	L2	L3	L4	L5	ΦP	🔩 ¹	🔩 ²
EPHT4-01	4	R 1/8	8	23.5	56.5	52.5	13.5	13	14	14
EPHT4-02		R 1/4	11	23.5	59.5	53.5	13.5	13	14	14
EPHT6-01	6	R 1/8	8	23.5	56.5	52.5	13.5	13	14	14
EPHT6-02		R 1/4	11	23.5	59.5	53.5	13.5	13	14	14
EPHT6-03		R 3/8	12	23.5	61.5	55	13.5	13	17	14
EPHT8-01	8	R 1/8	8	27.5	62	58	15	14.5	17	17
EPHT8-02		R 1/4	11	27.5	65	59	15	14.5	17	17
EPHT8-03		R 3/8	12	27.5	66	59.5	15	14.5	17	17
EPHT8-04		R 1/2	15	27.5	70	62	15	14.5	21	17
EPHT10-02	10	R 1/4	11	32	76.5	70.5	18.5	18.5	21	21
EPHT10-03		R 3/8	12	32	77.5	71	18.5	18.5	21	21
EPHT10-04		R 1/2	15	32	80.5	72.5	18.5	18.5	21	21
EPHT12-02	12	R 1/4	11	35	86	80	21.5	21	24	24
EPHT12-03		R 3/8	12	35	87	80.5	21.5	21	24	24
EPHT12-04		R 1/2	15	35	90	82	21.5	21	24	24